



LED EDGE-LIT DOWNLIGHT INSTALLATION GUIDE

The units covered in this report are intended to use Type IC or NON-IC covered ceiling recessed luminaire with through-branch wiring marked "Max. 8 of 12 AWG conductors" for L9EL4D4027K/30K/40K, L12EL6D4027K/30K/40K.

These products are intended to be used in dry or damp locations.

These products are Classified as to FIRE and SHOCK hazards only.

WARNING – Risk of fire or electric shock. LED Downlight installation requires knowledge of luminaires electrical systems. If not qualified, do not attempt installation. Contact a qualified electrician.

WARNING – Risk of fire or electric shock. Install this kit only in the luminaires that have the construction features and dimensions shown in the photographs and/or drawings.

Do not make or alter any open holes in an enclosure of wiring or electrical components during kit installation.

WARNING – To prevent wiring damage or abrasion, do not expose wiring to edges of sheet metal or other sharp objects.

Lamp replacement instructions shall indicate the manufacturer's custom lamp part number, and a method to order replacement lamps by phone, website and/or mail. These instructions shall be included on an information sheet packaged with each unit.

"MIN. LAMP COMPARTMENT DIMENSIONS 108(DIA) X 60 (H) mm" in format S16-L2 for models L9EL4D4027K/30K/40K.

"MIN. LAMP COMPARTMENT DIMENSIONS 160(DIA) X 60 (H) mm" in format S16-L2 for models L12EL6D4027K/30K/40K.

CAUTION: SHOCK AND FIRE HAZARD, DO NOT USE WHEN ENCLOSURE IS BROKEN

SUITABLE FOR TYPE IC OR NON-IC LUMINAIRES.

WARNING – RISK OF FIRE OR ELECTRIC SHOCK. DO NOT ALTER, RELOCATE, OR REMOVE WIRING, LAMPHOLDERS, POWER SUPPLY, OR ANY OTHER ELECTRICAL COMPONENT.

WARNING – RISK OF FIRE OR ELECTRIC SHOCK. INSTALLATION OF THIS KIT ASSEMBLY REQUIRES A PERSON FAMILIAR WITH THE CONSTRUCTION AND OPERATION OF THE LUMINAIRE'S ELECTRICAL SYSTEM AND THE HAZARD INVOLVED. IF NOT QUALIFIED, DO NOT ATTEMPT INSTALLATION. CONTACT A QUALIFIED ELECTRICIAN.

WARNING – Risk of fire or electric shock. Install this kit only in the luminaires that have the construction features and dimensions shown in the photographs and/or drawings.

Do not make or alter any open holes in an enclosure of wiring or electrical components during kit installation.

WARNING – TO PREVENT WIRING DAMAGE OR ABRASION. DO NOT EXPOSE WIRING TO EDGES OF SHEET METAL OR OTHER SHARP OBJECTS.

Before installing These products or doing any maintenance, make sure to turn off the power supply.



325 Campus Drive • Aurora, OH 44202
P: 1-800-324-1496 • tcp.com

Model	Input Voltage (V)	Input Frequency (Hz)	Input Watts (W)	Cut Out (mm)
L9EL4D4027K/30K/40K	120	60	8.5	Ç108 - Ç114
L12EL6D4027K/30K/40K	120	60	11.6	Ç160 - Ç168

STEP #1



TURN OFF POWER AT CIRCUIT BREAKER to prevent risk of electric shock.

STEP #2

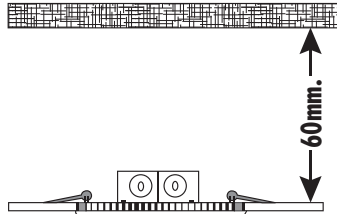

Allow adequate space in ceiling cavity for heat dissipation. Height of cavity should be at least 60mm (2.4").

STEP #3

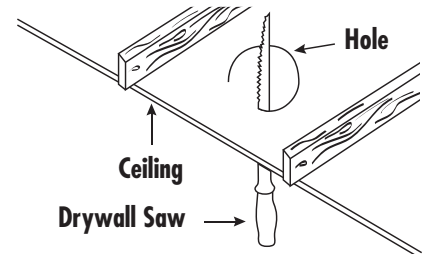

Carefully make a fixture installation hole in the ceiling using a drywall saw.

STEP #4

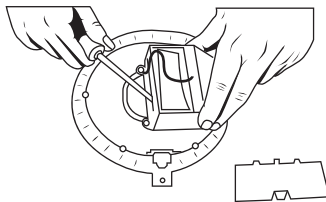

Carefully remove knock-out with a screwdriver or other similar tool.

STEP #5

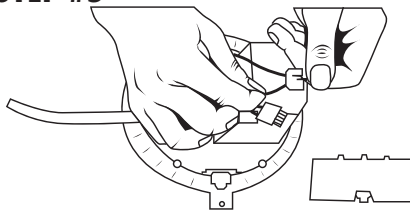

Connect electrical wires from the electric box (house wiring) into the correct inserts. Black is live and White is neutral.

STEP #6

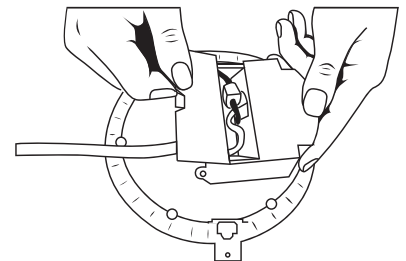

Replace wiring compartment door. Ensure it is closed securely. Make sure airtight gasket is positioned on back of trim.

STEP #7

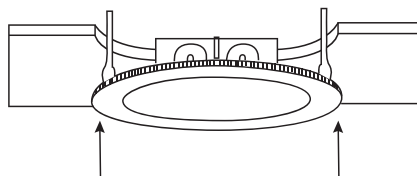

Hold the clip springs vertically, and slowly insert the fixture into the hole in the ceiling. The fixture will be successfully installed when it is flush against the ceiling.

STEP #8



Restore power to recessed fixture at circuitbreaker. Enjoy energy-efficient LED lighting, and up to 80% energy savings vs. equivalent incandescent bulbs.