



LED Barn Light

Product Specifications



TCP's LED Barn Light combines the look of a traditional barn light with the benefits of LED. An efficient alternative to HID, these barn lights deliver bright, uniform light while providing energy savings. A long 50,000 hour rated life significantly decreases maintenance labor and material costs over the life of the fixture.

The robust die-cast aluminum housing incorporates an impact-resistant polycarbonate lens. NEMA 3-pin photocontrol comes standard in the box. The Barn Light mounts directly to a wall or horizontal arm up to 3" nominal diameter for easy installation or retrofit of traditional luminaires.

Reasons to choose the LED Barn Light from TCP

- Long 50,000 hour rated life minimizes replacements and labor costs
- Efficiently delivers up to 150 LPW
- Impact-resistant polycarbonate lens
- Die-cast aluminum housing
- Outdoor Wet Location Rated
- Mounts to a wall or horizontal arm up to 3" nominal diameter

Ideal Applications

- Site Lighting
- Entrances
- General Area Lighting
- Security Lighting
- Perimeters





LED Barn Light

Applications

This product family can be effectively used in outdoor wall mount or horizontal arm mount locations. Applications include commercial, industrial, and rural exterior lighting: parking lots, cargo doors, high wall areas, and security.

Construction

- Die-cast aluminum housing
- Impact-resistant polycarbonate lens
- Durable, dark bronze powder coat
- Mounts to a wall or horizontal arm up to 3" nominal diameter

Electrical

- Outdoor Wet Location Rated
- Easily access wiring for quick installation
- System rated for long 50,000 hour life
- Efficiently delivers up to 150 LPW

Optics

- Delivers bright, white light and excellent uniformity
- Clear, impact-resistant polycarbonate outer lens

Item Number

Notes

Type



Listings

cETLus Listed
RoHS Compliant
Outdoor Wet Location Rated
DLC 5.1 Premium

Warranty

Five year limited warranty against defects in manufacturing

Dimensions

Optional Accessories

ITEM NUMBER	DESCRIPTION
BNLARM90	2 3/8" O.D. 90 DEGREE MOUNTING ARM (FASTENERS FOR WALL MOUNTING NOT INCLUDED)

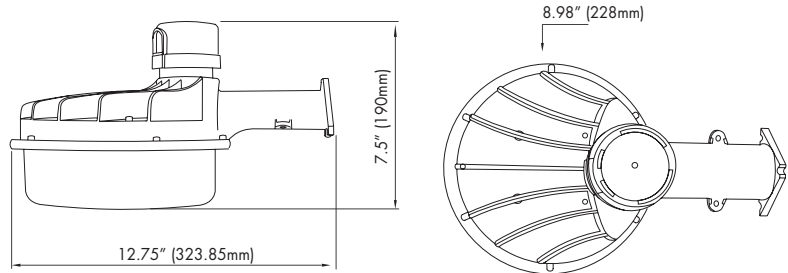

Catalog Ordering Matrix

Example: BNLZDA250KN3BR

FAMILY	VOLTAGE	DIMMING	LUMEN PACKAGE (Power) ^{1,2}	CCT	CONTROLS	COLOR
BNL = Barn Light	U = 120-277V	ZD = 0-10V	A2 = 6000 Lumens (40W) A3 = 9000 Lumens (60W)	40K - 4000K 50K - 5000K	N3 - NEMA 3 PIN Photocell	BR = Bronze

¹Approximate lumen output. Actual performance may vary based on CCT, options selected and end user application.

²Actual wattage may differ by +/- 10%.

For the most up-to-date specs and warranty information, please visit www.tcp.com



5 YEAR
WARRANTY

TECHNOLOGY CAST IN A BEAUTIFUL LIGHT

For over 20 years, TCP has been designing, developing and delivering energy-efficient lighting into the market. Thanks to our cutting-edge technology and manufacturing expertise, we have shipped billions of high quality lighting products. With TCP, you can count on a lighting product that is designed to meet the needs of the market - that transforms your surroundings and envelopes you in warmth - lighting that generates beauty with every flip of the switch.

Sales:

Date:

Model:

Project:

Rep:

Catalog Number:

Type:

Notes:



For more information on the quality and care TCP can deliver, call us at **800.324.1496** or visit tcpi.com

325 Campus Dr. | Aurora, Ohio 44202 | P: 800.324.1496 | F: 877.487.0516