



*Are you lighting hotels, offices,  
retail establishments and  
other locations?*

*...see the benefits  
of lighting with*

**TCP'S  
LED Luminaires**



# LED Direct Troffer Luminaires

## with Back-lit Technology

TCP's LED DIRECT TROFFER LUMINAIRES with back-lit technology feature a MORE ROBUST DESIGN than the edge-lit flat panel luminaires. Our direct troffers offer a slim, low-profile with full panel diffusion and superior uniformity over edge-lit.

These energy-efficient troffers offer a cost-effective solution to maximize savings and take advantage of utility rebates without sacrificing performance.

## FEATURES and BENEFITS

- Utilizes back-lit technology—providing even, uniform lighting
- Robust design—slightly thicker than a flat panel but look the same in a ceiling
- Fits in exiting footprint of standard t-bar grid
- Excellent light distribution and uniformity
- Durable, non-yellowing frosted diffuser
- Thin, sleek design for low clearance ceilings
- Contractor friendly packaging
- Detachable driver option available for speedy installation
- Wattage-selectable drivers available to reduce stocked inventory and easily customize in the field
- Multiple wattages allows for maximum utility rebates

LED DIRECT TROFFER LUMINAIRES with SELECTABLE WATTAGE	
Wattage (W)	2x2 - 23W / 29W / 38W 2x4 - 29W / 39W / 46W
Lumens (L)	2x2 - 2600L / 3200L / 4200L 2x4 - 3600L / 4200L / 5200L
LED DIRECT TROFFER LUMINAIRES with FIXED WATTAGE	
Wattage (W)	2x2 - 23W / 29W / 38W 2x4 - 29W / 39W / 46W
Lumens (L)	2x2 - 2600L / 3200L / 4200L 2x4 - 3600L / 4600L / 5200L



- Substantial energy savings over fluorescent alternatives
- Long 50,000 hour rated life
- Excellent color consistency & CRI of 80+
- Mercury free
- Fits standard 1" and 9/16" T-bar grid ceilings
- UL/cUL damp location rated
- 0-10V dimming driver (standard)
- 120° beam angle

Selectable and Fixed Wattage options available.

**CONTACT your TCP Representative for more information**



**5 YEAR**  
WARRANTY  
DLC v4.4 Standard

**7 YEAR**  
WARRANTY  
DLC v4.4 Premium

Not all versions of this product are qualified on the DLC GPL. To view our DLC qualified products, please consult the DLC Qualified Products List at [www.designlights.org/gpl](http://www.designlights.org/gpl).

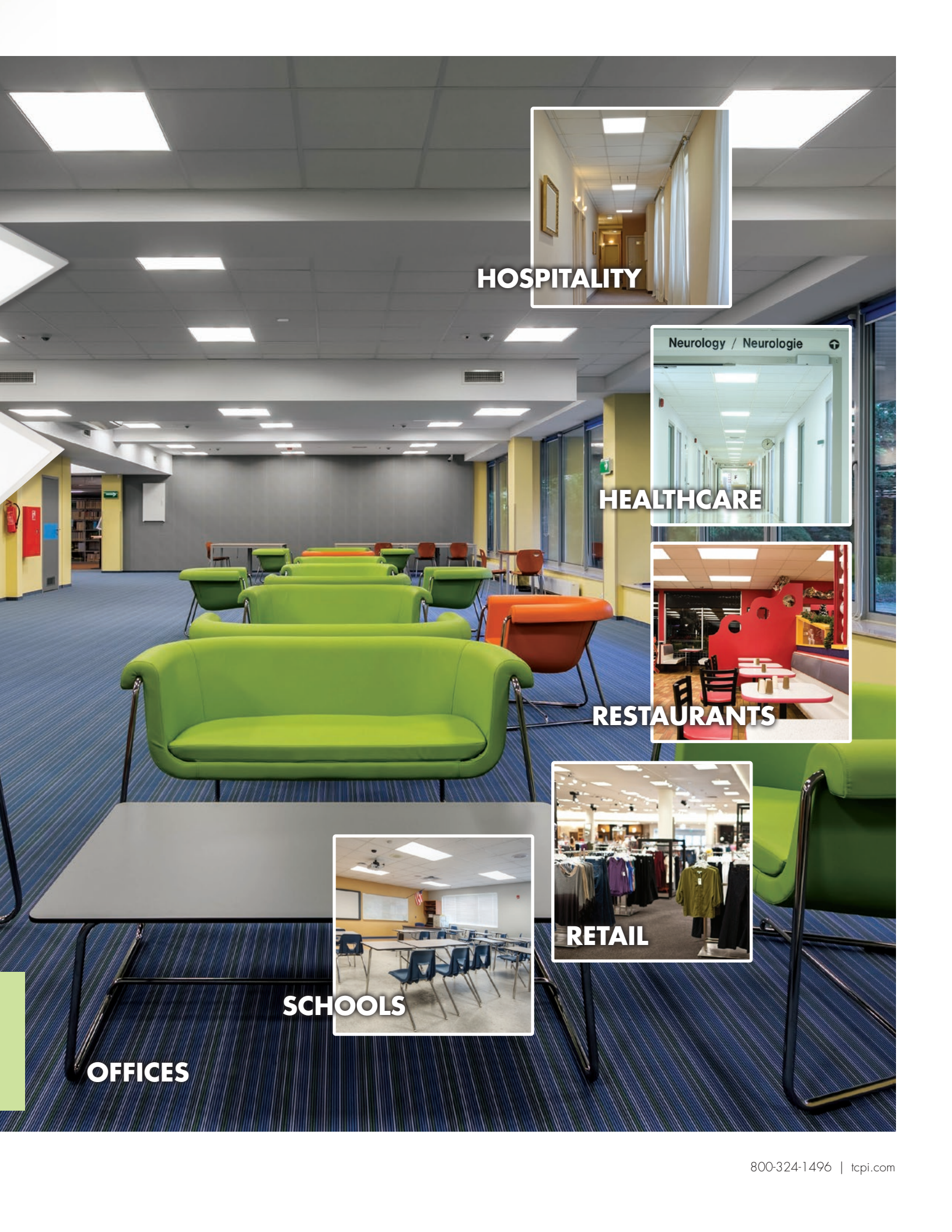

**HOSPITALITY**



**HEALTHCARE**



**RESTAURANTS**



**RETAIL**



**SCHOOLS**

**OFFICES**



## TCP® LED DIRECT TROFFER

# Limitless Lighting Options

## LENS FINISHES

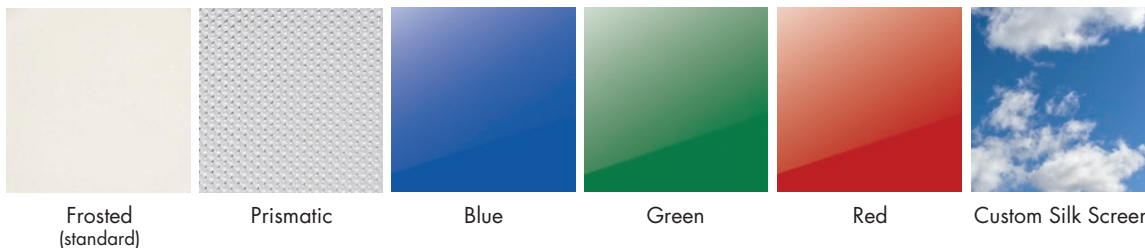

## SIZES

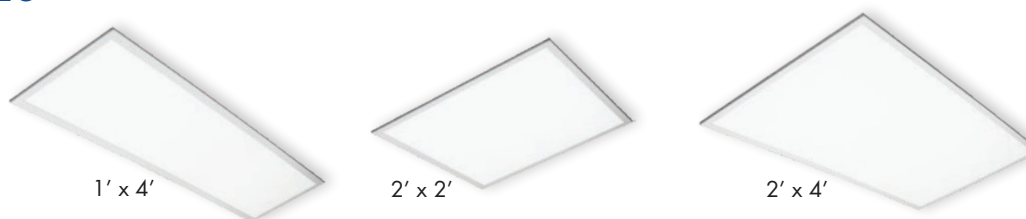

## FRAME COLOR OPTIONS

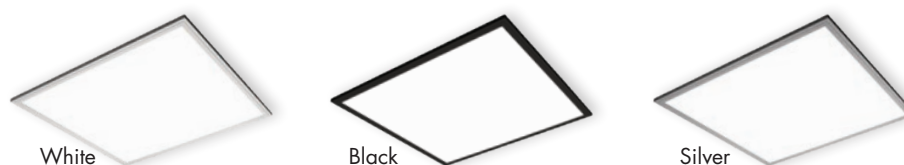

## HANGING KITS

SURFACE MOUNT KITS for  
1x4, 2x2 and 2x4 luminaires

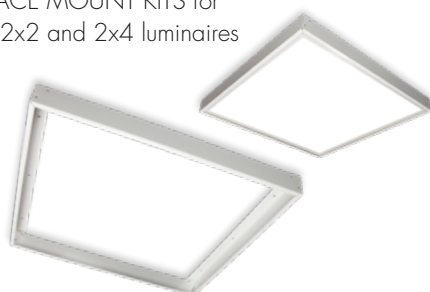

FLANGE KITS for  
1x4, 2x2 and 2x4  
luminaires



HANGING  
KITS



## COLOR TEMPERATURES

- 2700K (special order), 3000K, 3500K, 4000K, 5000K, 6500K (special order)
- Color Selectable – 35K, 40K and 50K
- RGBW (TCP SmartBox required)
- Allusion™ —smooth warm dimming  
*Allusion™*

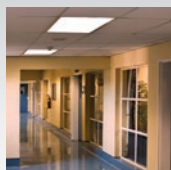

2700K  
(special order)

Soft white light provides a warm environment and gives a similar feeling to incandescent lighting.

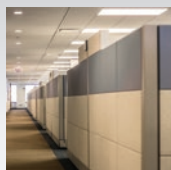

3000K – 3500K

This warm white light is slightly cooler than the 2700K and bathes products in an inviting glow.



4100K

With its cooler, white light our 4100K brings out product nuances and helps customers see detail more clearly.



5000K – 6500K  
(6500K special order)

Daylight LED bulbs are the perfect solution for creating an atmosphere close to true, natural outdoor light.

## DIMMING DRIVERS

0-10v Dimming  
Triac Dimming

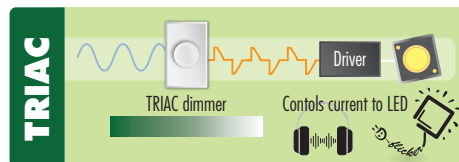
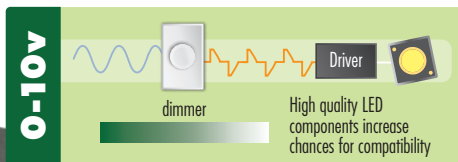

## TCP SMARTBOX

- Remote ON/OFF, with white light tuning and dimming control
- Make any existing 0-10v dimming luminaire smart using your smart phone or tablet
- Sensor compatible



## BATTERY BACK-UP

Emergency battery back-up option



## DLC QUALIFIED PRODUCTS



Not all versions of these products are qualified on the DLC QPL. To view our DLC qualified products, please consult the DLC Qualified Products List at [www.designlights.org/qpl](http://www.designlights.org/qpl).

# LED Flat Panel Luminaires

## with Edge-lit Technology

TCP'S LED FLAT PANEL LUMINAIRES are cost-effective, high-efficiency alternatives to traditional T5, T8 and T12 linear fluorescent troffers.

They utilize edge-lit technology and feature a slim, low-profile design with full panel diffusion and uniformity.

Applications include offices, schools, retail locations, healthcare, hospitality and other T-grid and commercial ceilings.



## FEATURES and BENEFITS

- Utilizes edge-lit technology
- Utilizes non-yellowing PMMA light guide
- Up to 51% less energy than fluorescent alternatives
- Long 50,000 hour rated life
- Slim, low-profile design
- Excellent color consistency & CRI of 80+
- Mercury free
- Fits standard 1" and 9/16" T-bar grid ceilings
- Emergency back-up option available

### Anatomy of LED Flat Panel with edge-lit technology

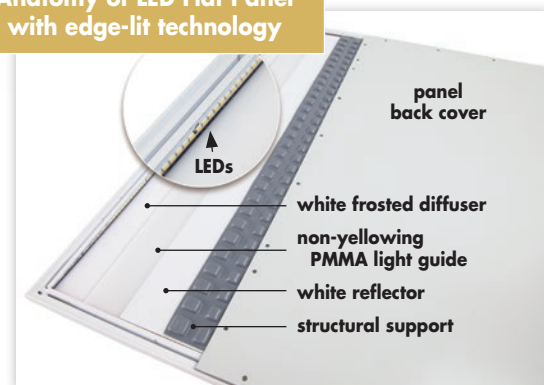

LED FLAT PANEL LUMINAIRES with SELECTABLE WATTAGE	
Wattage (W)	1x4 - 23W / 29W / 38W 2x2 - 23W / 29W / 38W 2x4 - 23W / 29W / 38W / 46W
Lumens (L)	1x4 - 3000L / 3650 / 4600L 2x2 - 3100L / 3900L / 5100L 2x4 - 3250L / 4000 / 5200L / 6000
LED FLAT PANEL LUMINAIRES with FIXED WATTAGE	
Wattage (W)	1x4 - 23W / 29W / 38W 2x2 - 23W / 29W / 38W 2x4 - 29W / 39W / 46W
Lumens (L)	1x4 - 2600L / 3200L / 4200L 2x2 - 2700L / 3200L / 4100L 2x4 - 3600L / 4600L / 5200L

- IP20 rated
- IC rated for direct contact with insulation
- Designed for easy drop into T-bar grid ceilings
- UL/cUL damp location rated
- 0-10V dimming driver (standard)
- Innovative edge-lit technology paired with acrylic light guide and thin frosted white diffuser
- 120° beam angle

Selectable and Fixed Wattage options available.

**CONTACT your TCP Representative for more information**



**5 YEAR**  
WARRANTY  
DLC v4.4 Standard

**7 YEAR**  
WARRANTY  
DLC v4.4 Premium

Not all versions of this product are qualified on the DLC QPL. To view our DLC qualified products, please consult the DLC Qualified Products List at [www.designlights.org/qpl](http://www.designlights.org/qpl).





**HOSPITALITY**



**HEALTHCARE**



**OFFICES**



**SCHOOLS**



**RETAIL**

**RESTAURANTS**



Technology Cast in a Beautiful Light



we know light.™

For more information on the quality and care that TCP® can deliver, call us at  
800.324.1496 or visit [tcpi.com](http://tcpi.com)

325 Campus Drive | Aurora, Ohio 44202 | P: 800.324.1496 | F: 877.487.0516